

Rail manufacturer



| Type of rail    | Size       | Type of carriage  | Item number                    | Adapting plate *1<br>(for height compensation) | Measure D [mm] | Measure table<br>(page 24 and 25) |
|-----------------|------------|---|--------------------------------|--|----------------|-----------------------------------|
| <b>SR / SSR</b> | 15         | SR..TB, SR..SB, SR..W, SR..V, SSR..XWY, SSR..XVY, SSR..XTBY                           | MK/MKS 1501 A                  |  | 24             | 1                                 |
|                 | 20         | SR..TB, SR..SB, SR..W, SR..V, SSR..XW, SSR..XV, SSR..XTB                              | MK/MKS 2001 A                  |  | 28             | 7                                 |
|                 | 25         | SR..TB, SR..SB, SR..W, SR..V, SSR..XWY, SSR..XVY, SSR..XTBY                           | MK/MKS 2501 A                  |  | 33             | 17                                |
|                 | 30         | SR..TB, SR..SB, SR..W, SR..V, SSR..XW   | MK/MKS 3001 A                  |  | 42             | 29                                |
|                 | 35         | SR..TB, SR..SB, SR..W, SR..V, SSR..XW   | MK/MKS 3501 A                  |  | 48             | 38                                |
|                 | 45         | SR..TB, SR..W   | MK/MKS 4501 A                  |  | 60             | 46                                |
|                 | 55         | SR..TB, SR..W   | MK/MKS 5501 SR                 |  | 68             | 55                                |
| <b>HSR</b>      | 15         | HSR..A, HSR..B  | MK/MKS 1501 A                  |  | 24             | 1                                 |
|                 |            | HSR..R  | MK/MKS 1501 A                  | PMK 15-4                                       | 28             |                                   |
|                 | 20         | HSR..A, HSR..LA, HSR..B, HSR..LB, HSR..R, HSR..LR, HSR..CA, HSR..HA, HSR..CB, HSR..HB | MK/MKS 2001 A                  |  | 30             | 9                                 |
|                 |            | HSR..R, HSR..LR   | MK/MKS 2501 A                  | PMK 25-4                                       | 40             |                                   |
|                 | 30         | HSR..A, HSR..LA, HSR..B, HSR..LB, HSR..CA, HSR..HA, HSR..CB, HSR..HB                  | MK/MKS 3001 A                  |  | 42             | 29                                |
|                 |            | HSR..R, HSR..LR   | MK/MKS 3001 A                  | PMK 30-3                                       | 45             |                                   |
|                 | 35         | HSR..A, HSR..LA, HSR..B, HSR..LB, HSR..CA, HSR..HA, HSR..CB, HSR..HB                  | MK/MKS 3501 A                  | PMK 35-3                                       | 48             | 36                                |
|                 |            | HSR..R, HSR..LR   | MK/MKS 3501 A                  | PMK 35-10                                      | 55             |                                   |
|                 | 45         | HSR..A, HSR..LA, HSR..B, HSR..LB, HSR..CA, HSR..HA, HSR..CB, HSR..HB                  | MK/MKS 4501 A                  |  | 60             | 46                                |
|                 |            | HSR..R, HSR..LR   | MK/MKS 4501 A                  | PMK 45-10                                      | 70             |                                   |
|                 | 55         | HSR..A, HSR..LA, HSR..B, HSR..LB, HSR..CA, HSR..HA, HSR..CB, HSR..HB                  | MK/MKS 5501 A                  |  | 70             | 56                                |
|                 |            | HSR..R, HSR..LR   | MK/MKS 5501 A                  | PMK 55-10                                      | 80             |                                   |
|                 | 65         | HSR..A, HSR..LA, HSR..B, HSR..LB, HSR..CA, HSR..HA, HSR..CB, HSR..HB, HSR..R, HSR..LR | MK/MKS 6501 A                  |  | 90             | 60                                |
|                 | <b>GSR</b> | 15  | GSR..T, GSR..V                 | ⊕  |                | 20                                |
| 20              |            | GSR..T, GSR..V  | MK/MKS 2001 G*                 |  | 24             | 5                                 |
| 25              |            | GSR..T, GSR..V  | MK/MKS 2501 G*                 |  | 30             | 23                                |
| 30              |            | GSR..T  | MK/MKS 3001 G*                 |  | 33             | 31                                |
| 35              |            | GSR..T  | MK/MKS 3501 G*                 |  | 38             | 32                                |
| <b>HRW</b>      | 17         | HRW..CA, HRW..CR  | MK/MKS 1701 B                  |  | 17             | 11                                |
|                 | 21         | HRW..CA, HRW..CR  | MK/MKS 2101 B*                 |  | 21             | 24                                |
|                 | 27         | HRW..CA, HRW..CR  | MK/MKS 2701 B*                 |  | 27             | 25                                |
|                 | 35         | HRW..CA, HRW..CR  | MK/MKS 3501 B                  |  | 35             | 49                                |
|                 | 50         | HRW..CA, HRW..CR  | MK/MKS 5001 B                  |  | 50             | 62                                |
|                 | 60         | HRW..CA   | ⊕                              |  | 60             |                                   |
| <b>SHW</b>      | 17         | SHW..CAM, SHW..CRM  | MK/MKS 1701 B                  |  | 17             | 11                                |
|                 | 21         | SHW..CA, SHW..CR  | MK/MKS 2101 B*                 |  | 21             | 24                                |
|                 | 27         | SHW..CA, SHW..CR  | MK/MKS 2701 B*                 |  | 27             | 25                                |
|                 | 35         | SHW..CA, SHW..CR  | MK/MKS 3501 B                  |  | 35             | 49                                |
|                 | 50         | SHW..CA, SHW..CR  | MK/MKS 5001 B                  |  | 50             | 62                                |
|                 | 60         | SHW..CA   | ⊕                              |  | 60             |                                   |
| <b>SNR/SNS</b>  | 25         | SNR..R, SNR..LR, SNR..C, SNR..LC, SNS..R, SNS..LR, SNS..C, SNS..LC                    | MK/MKS 2501 N                  |  | 31             | 61                                |
|                 |            | SNR..R, SNR..LR, SNR..C, SNR..LC, SNS..R, SNS..LR, SNS..C, SNS..LC                    | MK/MKS 3001 A                  |  | 38             | 26                                |
|                 | 35         | SNR..R, SNR..LR, SNR..C, SNR..LC, SNS..R, SNS..LR, SNS..C, SNS..LC                    | MK/MKS 3501 A                  |  | 44             | 37                                |
|                 |            | SNR..CH, SNR..LCH, SNS..CH, SNS..LCH<br>SNR..RH, SNR..LRH, SNS..RH, SNS..LRH          | ⊕<br>MK/MKS 3501 A             | PMK 35-11                                      | 55             |                                   |
|                 | 45         | SNR..R, SNR..LR, SNR..C, SNR..LC, SNS..R, SNS..LR, SNS..C, SNS..LC                    | MK/MKS 4501 A                  |  | 52             | 43                                |
|                 |            | SNR..CH, SNR..LCH, SNS..CH, SNS..LCH<br>SNR..RH, SNR..LRH, SNS..RH, SNS..LRH          | MK/MKS 4501 A<br>MK/MKS 4501 A | PMK 45-8<br>PMK 45-18                          | 60<br>70       |                                   |
|                 | 55         | SNR..R, SNR..LR, SNR..C, SNR..LC, SNS..R, SNS..LR, SNS..C, SNS..LC                    | MK/MKS 5501 A                  |  | 63             | 52                                |
|                 |            | SNR..CH, SNR..LCH, SNS..CH, SNS..LCH<br>SNR..RH, SNR..LRH, SNS..RH, SNS..LRH          | MK/MKS 5501 A<br>MK/MKS 5501 A | PMK 55-7<br>PMK 55-17                          | 70<br>80       |                                   |
|                 | 65         | SNR..R, SNR..LR, SNR..C, SNR..LC, SNS..R, SNS..LR, SNS..C, SNS..LC                    | MK/MKS 6501 N                  |  | 75             | 47                                |

\* PLUS connection not possible  
 \*1 Only required for high carriage design  
 \*2 Supplements the measure table and datasheet

See page 12 for part number explanation

| Type of rail | Size | Type of carriage  | Item number   | Adapting plate <sup>*1</sup><br>(for height compensation) | Measure D [mm] <sup>*2</sup> | Measure table<br>(page 24 and 25) |    |
|--------------|------|---|---|---|------------------------------|-----------------------------------|----|
| NR / NRS     | 25   | NR / NRS..XR, NR / NRS..XLR, NR / NRS..XA,<br>NR / NRS..XLA, NR / NRS..XB, NR / NRS..XLB              | MK/MKS 2501 N   |   | 31                           | 61                                |    |
|              | 30   | NR / NRS..R, NR / NRS..LR, NR / NRS..A,<br>NR / NRS..LA, NR / NRS..B, NR / NRS..LB                    | MK/MKS 3001 A   |   | 38                           | 26                                |    |
|              | 35   | NR / NRS..R, NR / NRS..LR, NR / NRS..A,<br>NR / NRS..LA, NR / NRS..B, NR / NRS..LB                    | MK/MKS 3501 A   |   | 44                           | 37                                |    |
|              | 45   | NR / NRS..R, NR / NRS..LR, NR / NRS..A,<br>NR / NRS..LA, NR / NRS..B, NR / NRS..LB                    | MK/MKS 4501 A   |   | 52                           | 43                                |    |
|              | 55   | NR / NRS..R, NR / NRS..LR, NR / NRS..A,<br>NR / NRS..LA, NR / NRS..B, NR / NRS..LB                    | MK/MKS 5501 A   |   | 63                           | 52                                |    |
|              | 65   | NR / NRS..R, NR / NRS..LR, NR / NRS..A,<br>NR / NRS..LA, NR / NRS..B, NR / NRS..LB                    | MK/MKS 6501 N   |   | 75                           | 47                                |    |
| SHS          | 15   | SHS..C, SHS..LC, SHS..V, SHS..LV<br>SHS..R  | MK/MKS 1501 A<br>MK/MKS 1501 A  |   | 24<br>28                     | 1                                 |    |
|              | 20   | SHS..C, SHS..LC, SHS..V, SHS..LV  | MK/MKS 2001 A   |   | 30                           | 9                                 |    |
|              | 25   | SHS..C, SHS..LC, SHS..V, SHS..LV<br>SHS..R, SHS..LR   | MK/MKS 2501 A<br>MK/MKS 2501 A  | PMK 25-2<br>PMK 25-6                                      | 36<br>40                     | 18                                |    |
|              | 30   | SHS..C, SHS..LC, SHS..V, SHS..LV<br>SHS..R, SHS..LR   | MK/MKS 3001 A<br>MK/MKS 3001 A  |   | 42<br>45                     | 29                                |    |
|              | 35   | SHS..C, SHS..LC, SHS..V, SHS..LV<br>SHS..R, SHS..LR   | MK/MKS 3501 A<br>MK/MKS 3501 A  | PMK 30-3<br>PMK 35-4<br>PMK 35-11                         | 48<br>55                     | 37                                |    |
|              | 45   | SHS..C, SHS..LC, SHS..V, SHS..LV<br>SHS..R, SHS..LR   | MK/MKS 4501 A<br>MK/MKS 4501 A  | PMK 45-6<br>PMK 45-16                                     | 60<br>70                     | 44                                |    |
|              | 55   | SHS..C, SHS..LC, SHS..V, SHS..LV<br>SHS..R, SHS..LR   | MK/MKS 5501 A<br>MK/MKS 5501 A  | PMK 55-6<br>PMK 55-16                                     | 70<br>80                     | 53                                |    |
|              | 65   | SHS..C, SHS..LC, SHS..V, SHS..LV  | MK/MKS 6501 A   |   | 90                           | 60                                |    |
|              | SRG  | 15  | SRG..A, SRG..V  | MK/MKS 1501 E   |                              | 24                                | 2  |
|              |      | 20  | SRG..A, SRG..LA, SRG..V, SRG..LV  | MK/MKS 2001 E   |                              | 30                                | 8  |
| 25           |      | SRG..C, SRG..LC<br>SRG..R, SRG..LR  | MK/MKS 2501 E<br>MK/MKS 2501 E  | PMK 25-5<br>PMK 25-9                                      | 36<br>40                     | 48                                |    |
| 30           |      | SRG..C, SRG..LC<br>SRG..R, SRG..LR  | MK/MKS 3001 E<br>MK/MKS 3001 E  | PMK 30-3  | 42<br>45                     | 15                                |    |
| 35           |      | SRG..C, SRG..LC<br>SRG..R, SRG..LR  | MK/MKS 3501 E<br>MK/MKS 3501 E  | PMK 35-7  | 48<br>55                     | 35                                |    |
| 45           |      | SRG..C, SRG..LC<br>SRG..R, SRG..LR  | MK/MKS 4501 E<br>MK/MKS 4501 E  | PMK 45-10   | 60<br>70                     | 42                                |    |
| 55           |      | SRG..C, SRG..LC<br>SRG..R, SRG..LR  | MK/MKS 5501 E<br>MK/MKS 5501 E  | PMK 55-7<br>PMK 55-17                                     | 70<br>80                     | 40                                |    |
| 65           |      | SRG..LC, SRG..LV  | MK/MKS 6501 E   | PMK 65-15   | 70                           | 39                                |    |
| HCR          |      | 15  | HCR 15A +60/150R<br>HCR 15A +60/300R<br>HCR 15A +60/400R  | MK/MKS 1501/150<br>MK/MKS 1501/300<br>MK/MKS 1501/400     |                              | 24                                | 64 |
|              |      | 25  | HCR 25A +60/500R<br>HCR 25A +60/750R<br>HCR 25A +60/1000R                                       | MK/MKS 2501/500<br>MK/MKS 2501/750<br>MK/MKS 2501/1000    |                              | 36                                | 65 |
|              | 35   | HCR 35A +60/600R<br>HCR 35A +60/800R<br>HCR 35A +60/1000R<br>HCR 35A +60/1300R                        | MK/MKS 3501/600<br>MK/MKS 3501/800<br>MK/MKS 3501/1000<br>MK/MKS 3501/1300                      |   | 48                           | 66                                |    |
|              | 45   | HCR 45A +60/800R<br>HCR 45A +60/1000R<br>HCR 45A +60/1200R<br>HCR 45A +60/1600R<br>HCR 45A +60/3850R  | MK/MKS 4501/800<br>MK/MKS 4501/1000<br>MK/MKS 4501/1200<br>MK/MKS 4501/1600<br>MK/MKS 4501/3850 |   | 60                           | 51                                |    |
|              | 65   | HCR 65A +60/1000R<br>HCR 65A +60/1500R<br>HCR 65A +45/2000R<br>HCR 65A +45/2500R<br>HCR 65A +30/3000R | ©   |   |                              |                                   |    |

Rail manufacturer



<sup>\*1</sup> Only required for high carriage design  
<sup>\*2</sup> Supplements the measure table and datasheet

See page 12 for part number explanation

Rail manufacturer  
**Rexroth**  
 Bosch Group

| Type of rail                 | Size                   | Type of carriage                                | Item number    | Adapting plate <sup>*1</sup><br>(for height compensation) | Measure D [mm] <sup>*2</sup> | Measure table<br>(page 24 and 25) |
|------------------------------|------------------------|---|----------------|---|------------------------------|-----------------------------------|
| 1605<br>1607<br>1645<br>1647 | 15                     | 1622, 1623, 1631, 1632, 1651, 1653, 1661, 1662, | MK/MKS 1505 AK |   | 24                           | 2                                 |
|                              |                        | 1665, 1666                                      |                |   |                              |                                   |
|                              |                        | 1621  | MK/MKS 1505 AK | PMK 15-4  | 28                           |                                   |
|                              | 20                     | 1622, 1623, 1651, 1653, 1661, 1662, 1665, 1666  | MK/MKS 2005 AK |   | 30                           | 8                                 |
|                              |                        | 1621, 1624                                      | MK/MKS 2505 AK | PMK 25-4  | 40                           |                                   |
|                              | 25                     | 1622, 1623, 1631, 1632, 1651, 1653, 1661, 1662, | MK/MKS 2505 AK |   | 36                           | 14                                |
|                              |                        | 1665, 1666                                      |                |   |                              |                                   |
|                              | 30                     | 1621, 1624                                      | MK/MKS 2505 AK | PMK 25-4  | 40                           |                                   |
|                              |                        | 1622, 1623, 1631, 1632, 1651, 1653, 1661, 1662, | MK/MKS 3005 AK |   | 42                           | 27                                |
|                              | 35                     | 1665, 1666                                      |                |   |                              |                                   |
|                              |                        | 1621, 1624                                      | MK/MKS 3005 AK | PMK 30-3  | 45                           |                                   |
|                              | 45                     | 1622, 1623, 1631, 1632, 1651, 1653, 1661, 1662, | MK/MKS 3505 AK |   | 48                           | 35                                |
|                              |                        | 1665, 1666                                      |                |   |                              |                                   |
|                              | 55                     | 1621, 1624                                      | MK/MKS 3505 AK | PMK 35-7  | 55                           |                                   |
|                              |                        | 1622, 1623, 1651, 1653                          | MK/MKS 4505 AK |   | 60                           | 42                                |
| 65                           | 1621, 1624             | MK/MKS 4505 AK                                  | PMK 45-10      | 70  |                              |                                   |
|                              | 1622, 1623, 1651, 1653 | MK/MKS 5505 AK                                  |                | 70  | 50                           |                                   |
| 65                           | 1621, 1624             | MK/MKS 5505 AK                                  | PMK 55-10      | 80  |                              |                                   |
|                              | 1622, 1623, 1651, 1653 | MK/MKS 6505 AK                                  |                | 90  | 59                           |                                   |
| 1675                         | 20                     | 1671  | MK/MKS 2005 KB |   | 27                           | 58                                |
| 1677                         | 25                     | 1671  | MK/MKS 2505 KB |   | 35                           | 41                                |
|                              | 35                     | 1671  | MK/MKS 3505 KB |   | 50                           | 63                                |
| 1805<br>1807                 | 25                     | 1851, 1853                                      | MK/MKS 2505 AR |   | 36                           | 14                                |
|                              |                        | 1821, 1824                                      | MK/MKS 2505 AR | PMK 25-4  | 40                           |                                   |
|                              | 35                     | 1851, 1853                                      | MK/MKS 3505 AR |   | 48                           | 35                                |
|                              |                        | 1821, 1824                                      | MK/MKS 3505 AR | PMK 35-7  | 55                           |                                   |
|                              | 45                     | 1851, 1853                                      | MK/MKS 4505 AR |   | 60                           | 42                                |
|                              |                        | 1821, 1824                                      | MK/MKS 4505 AR | PMK 45-10   | 70                           |                                   |
|                              | 55                     | 1851, 1853                                      | MK/MKS 5505 AR |   | 70                           | 51                                |
|                              |                        | 1821, 1824                                      | MK/MKS 5505 AR | PMK 55-10   | 80                           |                                   |
|                              | 65                     | 1853, 1824                                      | MK/MKS 6505 AR |   | 90                           | 59                                |

Rail manufacturer

**SCHNEEBERGER**  
 RAIL TECHNOLOGY

|    |    |   |                |           |    |    |
|----|----|---|----------------|-----------|----|----|
| MR | 25 | MR..A, MR..B                                    | MK/MKS 2503 MR |           | 36 | 14 |
|    |    | MR..C, MR..D, MR..E                             | MK/MKS 2503 MR | PMK 25-4  | 40 |    |
|    | 35 | MR..A, MR..B                                    | MK/MKS 3503 MR |           | 48 | 35 |
|    |    | MR..C, MR..D, MR..E                             | MK/MKS 3503 MR | PMK 35-7  | 55 |    |
|    | 45 | MR..A, MR..B                                    | MK/MKS 4503 MR |           | 60 | 42 |
|    |    | MR..C, MR..D                                    | MK/MKS 4503 MR | PMK 45-10 | 70 |    |
|    | 55 | MR..A, MR..B                                    | MK/MKS 5503 MR |           | 70 | 50 |
|    |    | MR..C, MR..D                                    | MK/MKS 5503 MR | PMK 55-10 | 80 |    |
|    | 65 | MR..B, MR..D                                    | MK/MKS 6503 MR |           | 90 | 59 |
| BM | 15 | BM..A, BM..F, BM..K                             | MK/MKS 1503 BM |           | 24 | 2  |
|    |    | BM..C   | MK/MKS 1503 BM | PMK 15-4  | 28 |    |
|    | 20 | BM..A, BM..B, BM..C, BM..D, BM..F, BM..G, BM..K | MK/MKS 2003 BM |           | 30 | 8  |
|    | 25 | BM..A, BM..B, BM..F, BM..G                      | MK/MKS 2503 BM |           | 36 | 10 |
|    |    | BM..C, BM..D, BM..E                             | MK/MKS 2503 BM | PMK 25-4  | 40 |    |
|    | 30 | BM..A, BM..B, BM..F, BM..G                      | MK/MKS 3003 BM |           | 42 | 27 |
|    |    | BM..C, BM..D, BM..E                             | MK/MKS 3003 BM | PMK 30-3  | 45 |    |
|    | 35 | BM..A, BM..B, BM..F, BM..G                      | MK/MKS 3503 BM |           | 48 | 35 |
|    |    | BM..C, BM..D, BM..E                             | MK/MKS 3503 BM | PMK 35-7  | 55 |    |
|    | 45 | BM..A, BM..B                                    | MK/MKS 4503 BM |           | 60 | 42 |
|    |    | BM..C, BM..D                                    | MK/MKS 4503 BM | PMK 45-10 | 70 |    |

<sup>\*1</sup> Only required for high carriage design

<sup>\*2</sup> Supplements the measure table and datasheet

See page 12 for part number explanation

| Type of rail | Size   | Type of carriage   | Item number   | Adapting plate <sup>*1</sup><br>(for height compensation) | Measure D [mm] <sup>*2</sup> | Measure table<br>(page 24 and 25) |
|--------------|--|--|---------------|---|------------------------------|-----------------------------------|
| LWH          | 15   | LWH..B, LWH..SL, LWH..M, LWHT..B, LWHT..SL, LWHT..M, LWSH..B, LWSH..SL, LWSH..M  | MK/MKS 1501 A |   | 24                           | 1                                 |
|              |  | LWHD..B, LWHD..M, LWHY   | MK/MKS 1501 A | PMK 15-4  | 28                           |                                   |
|              | 20   | LWH..B, LWH..SL, LWH..M, LWHG, LWHT..B, LWHT..SL, LWHT..M, LWHTG, LWSH..B, LWSH..SL, LWSH..M, LWSHG, LWHY  | MK/MKS 2001 A |   | 30                           | 9                                 |
|              |  | LWH..B, LWH..SL, LWH..M, LWHG, LWHT..B, LWHT..SL, LWHT..M, LWHTG, LWSH..B, LWSH..SL, LWSH..M, LWSHG  | MK/MKS 2501 A |   | 36                           | 19                                |
|              | 25   | LWHD..B, LWHD..M, LWHG, LWHT..B, LWHT..SL, LWHT..M, LWHTG, LWSH..B, LWSH..SL, LWSH..M, LWSHG   | MK/MKS 2501 A | PMK 25-4  | 40                           |                                   |
|              |  | LWHD..B, LWHD..M, LWHDG, LWHY  | MK/MKS 3001 A |   | 42                           | 29                                |
|              | 30   | LWH..B, LWH..SL, LWH..M, LWHG, LWHT..B, LWHT..SL, LWHT..M, LWHTG, LWSH..B, LWSH..SL, LWSH..M, LWSHG  | MK/MKS 3001 A | PMK 30-3  | 45                           |                                   |
|              |  | LWHD..B, LWHD..M, LWHDG, LWHY  | MK/MKS 3501 A |   | 48                           | 38                                |
|              | 35   | LWH..B, LWH..M, LWHG, LWHT..B, LWHT..M, LWHTG  | MK/MKS 3501 A | PMK 35-7  | 55                           |                                   |
|              |  | LWHD..B, LWHD..M, LWHDG, LWHY  | MK/MKS 4501 A | PMK 45-2  | 60                           | 46                                |
| 45           | LWH..B, LWH..M, LWHG, LWHT..B, LWHT..M, LWHTG      | MK/MKS 4501 A  | PMK 45-12     | 70  |                              |                                   |
|              | LWHD..B, LWHD..M, LWHDG, LWHY                      | MK/MKS 5501 A  |               | 70  | 56                           |                                   |
| 55           | LWH..B, LWHG, LWHT..B, LWHTG                       | MK/MKS 5501 A  | PMK 55-10     | 80  |                              |                                   |
|              | LWHD..B, LWHDG, LWHY                               | MK/MKS 6501 A  |               | 90  | 60                           |                                   |
| 65           | LWH..B, LWHG, LWHT..B, LWHTG, LWHD..B, LWHDG, LWHY | MK/MKS 6501 A  |               |   |                              |                                   |
|              |  |  |               |   |                              |                                   |
| LWE          | 15   | LWE..Q, LWET..Q, LWES..Q, LWEC, LWEC..SL, LWE, LWE..SL, LWEG, LWEG..SL, LWETC, LWETC..SL, LWET, LWET..SL; LWETG, LWETG..SL, LWESC, LWESC..SL, LWES, LWES..SL, LWESG, LWESG..SL | MK/MKS 1501 A |   | 24                           | 1                                 |
|              |  | LWE..Q, LWET..Q, LWES..Q, LWEC, LWEC..SL, LWE, LWE..SL, LWEG, LWEG..SL, LWETC, LWETC..SL, LWET, LWET..SL; LWETG, LWETG..SL, LWESC, LWESC..SL, LWES, LWES..SL, LWESG, LWESG..SL | MK/MKS 2001 A |   | 28                           | 7                                 |
|              | 25   | LWE..Q, LWET..Q, LWES..Q, LWEC, LWEC..SL, LWE, LWE..SL, LWEG, LWEG..SL, LWETC, LWETC..SL, LWET, LWET..SL; LWETG, LWETG..SL, LWESC, LWESC..SL, LWES, LWES..SL, LWESG, LWESG..SL | MK/MKS 2501 A |   | 33                           | 17                                |
|              |  | LWE..Q, LWET..Q, LWES..Q, LWEC, LWEC..SL, LWE, LWE..SL, LWEG, LWEG..SL, LWETC, LWETC..SL, LWET, LWET..SL; LWETG, LWETG..SL, LWESC, LWESC..SL, LWES, LWES..SL, LWESG, LWESG..SL | MK/MKS 3001 A |   | 42                           | 29                                |
|              | 35   | LWE..Q, LWET..Q, LWES..Q, LWEC, LWE, LWETC, LWET, LWESC, LWES  | MK/MKS 3501 A |   | 48                           | 38                                |
|              |  | LWE, LWET, LWES  | MK/MKS 4501 A |   | 60                           | 46                                |
| LRX          | 15   | LRXC, LRX, LRXG, LRXSC, LRXS, LRXSG  | MK/MKS 1501 A |   | 24                           | 1                                 |
|              |  | LRXDC, LRXD, LRXDG   | MK/MKS 1501 A |   | 28                           | 4                                 |
|              | 20   | LRXC, LRX, LRXG, LRXSC, LRXS, LRXSG  | MK/MKS 2010 B |   | 30                           | 9                                 |
|              |  | LRXDC, LRXD, LRXDG   | MK/MKS 2010 B | PMK 20-4  | 34                           |                                   |
|              | 25   | LRXC, LRX, LRXG, LRXSC, LRXS, LRXSG  | MK/MKS 2501 A |   | 36                           | 19                                |
|              |  | LRXDC, LRXD, LRXDG   | MK/MKS 2501 A |   | 40                           | 21                                |
|              | 30   | LRXC, LRX, LRXG, LRXSC, LRXS, LRXSG  | MK/MKS 3001 A |   | 42                           | 29                                |
|              |  | LRXDC, LRXD, LRXDG   | MK/MKS 3001 A |   | 45                           | 30                                |
|              | 35   | LRXC, LRX, LRXG  | MK/MKS 3501 A |   | 48                           | 38                                |
|              |  | LRXDC, LRXD, LRXDG   | MK/MKS 3501 A | PMK 35-7  | 55                           |                                   |
|              | 45   | LRXC, LRX, LRXG  | MK/MKS 4501 A |   | 60                           | 46                                |
|              |  | LRXDC, LRXD, LRXDG   | MK/MKS 4501 A | PMK45-10  | 70                           |                                   |
|              | 55   | LRXC, LRX, LRXG  | MK/MKS 5501 A |   | 70                           | 56                                |
|              |  | LRXDC, LRXD, LRXDG   | MK/MKS 5501 A | PMK 55-10   | 80                           |                                   |
| 65           | LRXDC, LRXD, LRXDG                                 | Ⓒ  |               | 90  |                              |                                   |



**LRX:** This table applies only for rail use without cover sheet!

\* PLUS connection not possible

\*<sup>1</sup> Only required for high carriage design

\*<sup>2</sup> Supplements the measure table and datasheet

See page 12 for part number explanation

Rail manufacturer



| Type of rail   | Size   | Type of carriage   | Item number  | Adapting plate <sup>*1</sup><br>(for height compensation) | Measure D [mm] | Measure table <sup>*2</sup><br>(page 24 and 25) |    |
|----------------|--|--|--|---|----------------|---|----|
| TKD<br>(KUE)   | 15   | KWE  | MK/MKS 1501 A  |   | 24             | 1   |    |
|                |  | KWE..-H  | MK/MKS 1501 A  | PMK 15-4  | 28             |   |    |
|                | 20   | KWE, KWE..-H   | MK/MKS 2001 A  |   | 30             | 9   |    |
|                |  | KWE  | MK/MKS 2501 A  | PMK 25-4  | 36             | 16  |    |
|                | 25   | KWE..-H  | MK/MKS 2501 A  | PMK 25-8  | 40             |   |    |
|                |  | KWE  | MK/MKS 3001 A  | PMK 30-2  | 42             | 28  |    |
|                | 30   | KWE..-H  | MK/MKS 3001 A  | PMK 30-5  | 45             |   |    |
|                |  | KWE  | MK/MKS 3501 A  | PMK 35-8  | 48             | 33  |    |
| 35             | KWE..-H  | MK/MKS 3501 A  | PMK 35-15  | 55  |                |   |    |
|                | TKSD<br>(KUSE)                                 | 20   | KWSE, KWSE..-L, KWSE..-H, KWSE..-HL  | MK/MKS 2001 A   |                | 30  | 9  |
| 25             |  | KWSE, KWSE..-L   | MK/MKS 2501 A  |   | 36             | 19  |    |
|                |  | KWSE..-H, KWSE..-HL  | MK/MKS 2501 A  | PMK 25-4  | 40             |   |    |
| 30             |  | KWSE, KWSE..-L   | MK/MKS 3001 A  |   | 42             | 29  |    |
|                |  | KWSE..-H, KWSE..-HL  | MK/MKS 3001 A  | PMK 30-3  | 45             |   |    |
| 35             |  | KWSE, KWSE..L  | MK/MKS 3501 A  |   | 48             | 38  |    |
|                |  | KWSE..-H, KWSE..-HL  | MK/MKS 3501 A  | PMK 35-7  | 55             |   |    |
| 45             |  | KWSE, KWSE..-L   | MK/MKS 4501 A  |   | 60             | 46  |    |
|                |  | KWSE..-H, KWSE..-HL  | MK/MKS 4501 A  | PMK 45-10   | 70             |   |    |
| 55             |  | KWSE, KWSE..-L   | MK/MKS 5501 A  |   | 70             | 56  |    |
|                |  | KWSE..-H, KWSE..-HL  | MK/MKS 5501 A  | PMK 55-10   | 80             |   |    |
| TKVD<br>(KUVE) |  | 15   | KWVE..-B, KWVE..-B-EC, KWVE..-E, KWVE..-ES, KWVE..-B-ESC, KWVE..-B-S, KWVE..-B-KT, KWVE..-B-KT-L, KWVE..-B-KT-S, KWVE..-B-KT-SL, KWVE..-B-H, KWVE..-B-KT-H, KWVE..-B-KT-HL | MK/MKS 1502 K   |                | 24  | 1  |
|                |  |  | KWVE..-B, KWVE..-B-L, KWVE..-B-S, KWVE..-B-SL, KWVE..-B-KT, KWVE..-B-KT-L, KWVE..-B-KT-S, KWVE..-B-KT-SL, KWVE..-B-N, KWVE..-B-NL, KWVE..-B-SN, KWVE..-B-SNL               | MK/MKS 1502 K   | PMK 15-4       | 28  |    |
|                |  | 20   | KWVE..-B, KWVE..-B-L, KWVE..-B-S, KWVE..-B-SL, KWVE..-B-KT, KWVE..-B-KT-L, KWVE..-B-KT-S, KWVE..-B-KT-SL, KWVE..-B-N, KWVE..-B-NL, KWVE..-B-SN, KWVE..-B-SNL               | MK/MKS 2002 K   |                | 30  | 9  |
|                | KWVE..-E, KWVE..-B-EC, KWVE..-ES, KWVE..-B-ESC |  | MK/MKS 2002 K  |   | 27             | 6   |    |
|                | 25   | KWVE..-B, KWVE..-B-L, KWVE..-B-S, KWVE..-B-SL, KWVE..-SN-K, KWVE..-B-KT, KWVE..-B-KT-L, KWVE..-B-KT-S, KWVE..-B-KT-SL                                      | MK/MKS 2502 K  | PMK 25-2  | 28             | 7   |    |
|                |  | KWVE..-B-N, KWVE..-B-NL, KWVE..-B-SN, KWVE..-B-SNL, KWVE..-E, KWVE..-B-EC, KWVE..-ES, KWVE..-B-ESC, KWVE..-ES-K, KWVE..-ESC-K                              | MK/MKS 2502 K  |   | 36             | 18  |    |
|                | 30   | KWVE..-B-N, KWVE..-B-NL, KWVE..-B-SN, KWVE..-B-SNL, KWVE..-E, KWVE..-B-EC, KWVE..-ES, KWVE..-B-ESC, KWVE..-B-H, KWVE..-B-HL, KWVE..-B-KT-H, KWVE..-B-KT-HL | MK/MKS 2502 K  |   | 31             | 12  |    |
|                |  | KWVE..-E, KWVE..-B-EC, KWVE..-ES, KWVE..-B-ESC, KWVE..-ES-K, KWVE..-ESC-K  | MK/MKS 2502 K  |   | 33             | 17  |    |
|                | 35   | KWVE..-B, KWVE..-B-EC, KWVE..-B-L, KWVE..-E, KWVE..-ES, KWVE..-B-ESC, KWVE..-B-S, KWVE..-B-SL, KWVE..-B-KT, KWVE..-B-KT-L, KWVE..-B-KT-S, KWVE..-B-KT-SL   | MK/MKS 2502 K  | PMK 25-6  | 40             | 18  |    |
|                |  | KWVE..-B-N, KWVE..-B-NL, KWVE..-B-SN, KWVE..-B-SNL, KWVE..-B-H, KWVE..-B-HL, KWVE..-B-KT-H, KWVE..-B-KT-HL   | MK/MKS 2502 K  |   | 42             | 29  |    |
|                | 45   | KWVE..-B, KWVE..-B-EC, KWVE..-B-L, KWVE..-E, KWVE..-ES, KWVE..-B-ESC, KWVE..-B-S, KWVE..-B-SL, KWVE..-B-KT, KWVE..-B-KT-L, KWVE..-B-KT-S, KWVE..-B-KT-SL   | MK/MKS 3002 K  |   | 38             | 26  |    |
|                |  | KWVE..-B-N, KWVE..-B-NL, KWVE..-B-SN, KWVE..-B-SNL, KWVE..-B-H, KWVE..-B-HL, KWVE..-B-KT-H, KWVE..-B-KT-HL   | MK/MKS 3002 K  | PMK 30-3  | 45             | 29  |    |
|                | 55   | KWVE..-B, KWVE..-B-EC, KWVE..-B-L, KWVE..-E, KWVE..-ES, KWVE..-B-ESC, KWVE..-B-S, KWVE..-B-SL, KWVE..-B-KT, KWVE..-B-KT-L, KWVE..-B-KT-S, KWVE..-B-KT-SL   | MK/MKS 3502 K  |   | 48             | 38  |    |
|                |  | KWVE..-B-N, KWVE..-B-NL, KWVE..-B-SN, KWVE..-B-SNL, KWVE..-B-H, KWVE..-B-HL, KWVE..-B-KT-H, KWVE..-B-KT-HL   | MK/MKS 3502 K  | PMK 35-11   | 55             | 37  |    |
|                | 45   | KWVE..-B, KWVE..-B-EC, KWVE..-B-L, KWVE..-E, KWVE..-ES, KWVE..-B-ESC, KWVE..-B-S, KWVE..-B-SL, KWVE..-B-KT, KWVE..-B-KT-L, KWVE..-B-KT-S, KWVE..-B-KT-SL   | MK/MKS 3502 K  |   | 44             | 37  |    |
|                |  | KWVE..-B-N, KWVE..-B-NL, KWVE..-B-SN, KWVE..-B-SNL, KWVE..-B-H, KWVE..-B-HL, KWVE..-B-KT-H, KWVE..-B-KT-HL   | MK/MKS 3502 K  | PMK 35-11   | 55             | 37  |    |
|                | 45   | KWVE..-B, KWVE..-B-EC, KWVE..-B-L, KWVE..-E, KWVE..-ES, KWVE..-B-ESC, KWVE..-B-S, KWVE..-B-SL, KWVE..-B-KT, KWVE..-B-KT-L, KWVE..-B-KT-S, KWVE..-B-KT-SL   | MK/MKS 4502 K  |   | 60             | 46  |    |
|                |  | KWVE..-B-N, KWVE..-B-NL, KWVE..-B-SN, KWVE..-B-SNL, KWVE..-B-H, KWVE..-B-HL, KWVE..-B-KT-H, KWVE..-B-KT-HL   | MK/MKS 4502 E  |   | 52             | 54  |    |
|                | 55   | KWVE..-B, KWVE..-B-L, KWVE..-B-S, KWVE..-B-SL, KWVE..-B-KT, KWVE..-B-KT-L, KWVE..-B-KT-S, KWVE..-B-KT-SL   | MK/MKS 4502 K  | PMK 45-10   | 70             | 46  |    |
|                |  |  |  |   | 70             |   |    |
|                | TKVD - W<br>(KUVE-W)                           | 15   | KWVE..-W   | MK/MKS 1502 KB*   |                | 21  | 57 |
|                |  | 20   | KWVE..-W   | MK/MKS 2002KB   |                | 30  | 13 |
|                |  | 25   | KWVE..-WL, KWVE..-B-KT-W, KWVE..-B-KT-WL   | MK/MKS 2502KB   |                | 35  | 49 |
|                |  | 30   | KWVE..-W   | MK/MKS 3002KB   |                | 42  | 3  |
|                |  | 35   | KWVE..-WL  | MK/MKS 3502KB   |                | 50  | 62 |

\* PLUS connection not possible

\*<sup>1</sup> Only required for high carriage design

\*<sup>2</sup> Supplements the measure table and datasheet

See page 12 for part number explanation

| Type of rail     | Size | Type of carriage                        | Item number    | Adapting plate <sup>*1</sup><br>(for height compensation) | Measure D [mm] | Measure table<br>(page 24 and 25) <sup>*2</sup> |
|------------------|------|---|----------------|---|----------------|---|
| TSX - E<br>(RUE) | 25   | RWU...-D, RWU...-D-L                    | MK/MKS 2502 R* | PMK 25-2  | 36             | 18  |
|                  |      | RWU...-D-H, RWU...-D-HL                 | MK/MKS 2502 R* | PMK 25-6  | 40             |   |
|                  | 35   | RWU...-E, RWU...-E-L, RWU...-E-KT-L     | MK/MKS 3502 R* | PMK 35-3  | 48             | 36  |
|                  |      | RWU...-E-H, RWU...-E-HL, RWU...-E-KT-HL | MK/MKS 3502 R* | PMK 35-10   | 55             |   |
|                  | 45   | RWU...-E, RWU...-E-L, RWU...-E-KT-L     | MK/MKS 4502 R* | PMK 45-2  | 60             | 45  |
|                  |      | RWU...-E-H, RWU...-E-HL, RWU...-E-KT-HL | MK/MKS 4502 R* | PMK 45-12   | 70             |   |
|                  | 55   | RWU...-E, RWU...-E-L, RWU...-E-KT-L     | MK/MKS 5502 R* |   | 70             | 50  |
|                  |      | RWU...-E-H, RWU...-E-HL, RWU...-E-KT-HL | MK/MKS 5502 R* | PMK 55-10   | 80             |   |
|                  | 65   | RWU...-E, RWU...-E-L                    | MK/MKS 6502 R* |   | 90             | 60  |
|                  |      | RWU...-E-H, RWU...-E-HL                 | MK/MKS 6502 R* | PMK 65-10   | 100            |   |

Rail manufacturer



|    |  |  |  |               |    |    |   |
|----|--|--|--|---------------|----|----|---|
| LH | 15   | LAH..EMZ, LAH..GMZ                               | MK/MKS 1501 A                                    |               | 24 | 1  |   |
|    |  | LAH..ANZ, LAH..BNZ                               | MK/MKS 1501 A                                    | PMK 15-4      | 28 |    |   |
|    | 20   | LAH..EMZ, LAH..GMZ, LAH..ANZ, LAH..BNZ           | MK/MKS 2001 A                                    |               | 30 | 9  |   |
|    |  | LAH..EMZ, LAH..GMZ, LAH..ALZ, LAH..BLZ           | MK/MKS 2501 A                                    |               | 36 | 19 |   |
|    | 25   | LAH..ANZ, LAH..BNZ                               | MK/MKS 2501 A                                    | PMK 25-4      | 40 |    |   |
|    |  | LAH..EMZ, LAH..GMZ, LAH..ALZ, LAH..BLZ           | MK/MKS 3001 A                                    |               | 42 | 29 |   |
|    | 30   | LAH..ANZ, LAH..BNZ                               | MK/MKS 3001 A                                    |               | 45 | 30 |   |
|    |  | LAH..EMZ, LAH..GMZ, LAH..ALZ, LAH..BLZ           | MK/MKS 3501 A                                    |               | 48 | 38 |   |
|    | 35   | LAH..ANZ, LAH..BNZ                               | MK/MKS 3501 A                                    | PMK 35-7      | 55 |    |   |
|    |  | LAH..EMZ, LAH..GMZ                               | MK/MKS 4501 A                                    |               | 60 | 46 |   |
|    | 55   | LAH..ANZ, LAH..BNZ                               | MK/MKS 4501 A                                    | PMK 45-10     | 70 |    |   |
|    |  | LAH..EMZ, LAH..GMZ                               | MK/MKS 5501 A                                    |               | 70 | 56 |   |
| 65 | LAH..ANZ, LAH..BNZ                               | MK/MKS 5501 A                                    | PMK 55-10  | 80            |    |    |   |
|    | LAH..EMZ, LAH..GMZ, LAH..ANZ, LAH..BNZ           | MK/MKS 6501 A                                    |  | 90            | 60 |    |   |
| SH | 15   | SAH..EMZ, SAH..GMZ                               | MK/MKS 1501 A                                    |               | 24 | 1  |   |
|    |  | SAH..ANZ, SAH..BNZ                               | MK/MKS 1501 A                                    | PMK 15-4      | 28 |    |   |
|    | 20   | SAH..EMZ, SAH..GMZ, SAH..ANZ, SAH..BNZ           | MK/MKS 2001 A                                    |               | 30 | 9  |   |
|    |  | SAH..EMZ, SAH..GMZ, SAH..ALZ, SAH..BLZ           | MK/MKS 2501 A                                    |               | 36 | 19 |   |
|    | 25   | SAH..ANZ, SAH..BNZ                               | MK/MKS 2501 A                                    | PMK 25-4      | 40 |    |   |
|    |  | SAH..EMZ, SAH..GMZ, SAH..ALZ, SAH..BLZ           | MK/MKS 3001 A                                    |               | 42 | 29 |   |
|    | 30   | SAH..ANZ, SAH..BNZ                               | MK/MKS 3001 A                                    |               | 45 | 30 |   |
|    |  | SAH..EMZ, SAH..GMZ, SAH..ALZ, SAH..BLZ           | MK/MKS 3501 A                                    |               | 48 | 38 |   |
|    | 35   | SAH..ANZ, SAH..BNZ                               | MK/MKS 3501 A                                    | PMK 35-7      | 55 |    |   |
|    |  | SAH..EMZ, SAH..GMZ, SAH..ALZ, SAH..BLZ           | MK/MKS 3501 A                                    |               | 55 |    |   |
|    | LS   | 15   | LAS..KLZ, LAS..JMZ, LAS..EMZ, LAS..CLZ, LAS..ALZ | MK/MKS 1501 A |    | 24 | 1 |
|    |  | 20   | LAS..KLZ, LAS..JMZ, LAS..EMZ, LAS..CLZ, LAS..ALZ | MK/MKS 2001 A |    | 28 | 7 |
| 25 |  | LAS..KLZ, LAS..JMZ, LAS..EMZ, LAS..CLZ, LAS..ALZ | MK/MKS 2501 A                                    |               | 33 | 17 |   |
| 30 |  | LAS..KLZ, LAS..FLZ, LAS..ELZ, LAS..CLZ, LAS..ALZ | MK/MKS 3001 A                                    |               | 42 | 29 |   |
| 35 |  | LAS..KLZ, LAS..FLZ, LAS..ELZ, LAS..CLZ, LAS..ALZ | MK/MKS 3501 A                                    | PMK 35-4      | 48 | 37 |   |
| SS | 15   | SAS..KLZ, SAS..EMZ, SAS..CLZ, SAS..ALZ           | MK/MKS 1501 A                                    |               | 24 | 1  |   |
|    | 20   | SAS..KLZ, SAS..EMZ, SAS..CLZ, SAS..ALZ           | MK/MKS 2001 A                                    |               | 28 | 7  |   |
|    | 25   | SAS..KLZ, SAS..EMZ, SAS..CLZ, SAS..ALZ           | MK/MKS 2501 A                                    |               | 33 | 17 |   |
|    | 30   | SAS..KLZ, SAS..EMZ, SAS..CLZ, SAS..ALZ           | MK/MKS 3001 A                                    |               | 42 | 29 |   |
|    | 35   | SAS..KLZ, SAS..EMZ, SAS..CLZ, SAS..ALZ           | MK/MKS 3501 A                                    | PMK 35-4      | 48 | 37 |   |
| LY | 15   | LY..EL, LY.. FL, LY..AL                          | MK/MKS 1501 A                                    |               | 24 | 1  |   |
|    |  | LY..AN   | MK/MKS 1501 A                                    | PMK 15-4      | 28 |    |   |
|    | 20   | LY..EL, LY..FL, LY.. GL, LY.. HL, LY..AL, LY..BL | MK/MKS 2001 A                                    |               | 30 | 9  |   |
|    |  | LY..EL, LY..FL, LY.. GL, LY.. HL, LY..AL, LY..BL | MK/MKS 2501 A                                    |               | 36 | 19 |   |
|    | 25   | LY..AN, LY..BN                                   | MK/MKS 2501 A                                    | PMK 25-4      | 40 |    |   |
|    |  | LY..EL, LY..FL, LY.. GL, LY.. HL, LY..AL, LY..BL | MK/MKS 3001 A                                    |               | 42 | 29 |   |
|    | 30   | LY..AN, LY..BN                                   | MK/MKS 3001 A                                    |               | 45 | 30 |   |
|    |  | LY..EL, LY..FL, LY.. GL, LY.. HL, LY..AL, LY..BL | MK/MKS 3501 A                                    |               | 48 | 38 |   |
|    | 35   | LY..AN, LY..BN                                   | MK/MKS 3501 A                                    | PMK 35-7      | 55 |    |   |
|    |  | LY..EL, LY..FL, LY.. GL, LY.. HL, LY..AL, LY..BL | MK/MKS 4501 A                                    |               | 60 | 46 |   |
|    | 45   | LY..AN, LY..BN                                   | MK/MKS 4501 A                                    | PMK 45-10     | 70 |    |   |
|    |  | LY..EL, LY..FL, LY.. GL, LY.. HL, LY..AL, LY..BL | MK/MKS 5501 A                                    |               | 70 | 56 |   |
| 55 | LY..AN, LY..BN                                   | MK/MKS 5501 A                                    | PMK 55-10  | 80            |    |    |   |
|    | LY..EL, LY..FL, LY.. GL, LY.. HL, LY..AN, LY..BN | MK/MKS 6501 A                                    |  | 90            | 60 |    |   |

Rail manufacturer



\* PLUS connection not possible  
<sup>\*1</sup> Only required for high carriage design  
<sup>\*2</sup> Supplements the measure table and datasheet

See page 12 for part number explanation

Rail manufacturer

**NSK**

| Type of rail   | Size   | Type of carriage                               | Item number    | Adapting plate *1<br>(for height compensation) | Measure D [mm] | Measure table<br>(page 24 and 25) |
|----------------|--|--|----------------|--|----------------|-----------------------------------|
| LA             | 25   | LA..EL, LA..GL, LA..FL, LA..HL                 | MK/MKS 2501 A  |  | 36             | 19                                |
|                |  | LA..AN, LA..BN                                 | MK/MKS 2501 A  | PMK 25-4                                       | 40             |                                   |
|                | 30   | LA..EL, LA..GL, LA..FL, LA..HL                 | MK/MKS 3001 A  |  | 42             | 29                                |
|                |  | LA..AN, LA..BN                                 | MK/MKS 3001 A  |  | 45             | 30                                |
|                | 35   | LA..EL, LA..GL, LA..FL, LA..HL, LA..AL, LA..BL | MK/MKS 3501 A  |  | 48             | 38                                |
|                |  | LA..AN, LA..BN                                 | MK/MKS 3501 A  | PMK 35-7                                       | 55             |                                   |
|                | 45   | LA..EL, LA..GL, LA..FL, LA..HL, LA..AL, LA..BL | MK/MKS 4501 A  |  | 60             | 46                                |
|                |  | LA..AN, LA..BN                                 | MK/MKS 4501 A  | PMK 45-10                                      | 70             |                                   |
|                | 55   | LA..EL, LA..GL, LA..FL, LA..HL, LA..AL, LA..BL | MK/MKS 5501 A  |  | 70             | 56                                |
|                |  | LA..AN, LA..BN                                 | MK/MKS 5501 A  | PMK 55-10                                      | 80             |                                   |
| 65             | LA..EL, LA..GL, LA..FL, LA..HL, LA..AN, LA..BN | MK/MKS 6501 A                                  |                | 90   | 60             |                                   |
| LW             | 17   | LW..ELZ  | MK/MKS 1701 B  |  | 17             | 11                                |
|                | 21   | LW..ELZ  | MK/MKS 2101 B* |  | 21             | 24                                |
|                | 27   | LW..ELZ  | MK/MKS 2701 B* |  | 27             | 25                                |
|                | 35   | LW..ELZ  | MK/MKS 3501 B  |  | 35             | 49                                |
|                | 50   | LW..ELZ  | MK/MKS 5001 B  |  | 50             | 62                                |
| RA             | 15   | RA..AL, RA..BL, RA..EM, RA..GM                 | ⊙              |  | 24             |                                   |
|                |  | RA..AN, RA..BN                                 | ⊙              |  | 28             |                                   |
|                | 20   | RA..EM, RA..GM, RA..AN, RA..BN                 | ⊙              |  | 30             |                                   |
|                | 25   | RA..AL, RA..BL, RA..EM, RA..GM                 | MK/MKS 2505 AR |  | 36             | 14                                |
|                |  | RA..AN, RA..BN                                 | MK/MKS 2505 AR | PMK 25-4                                       | 40             |                                   |
|                | 30   | RA..AL, RA..BL, RA..EM, RA..GM                 | MK/MKS 3004 F  |  | 42             | 15                                |
|                |  | RA..AN, RA..BN                                 | MK/MKS 3004 F  | PMK 30-3                                       | 45             |                                   |
|                | 35   | RA..AL, RA..BL, RA..EM, RA..GM                 | ⊙              |  | 48             |                                   |
|                |  | RA..AN, RA..BN                                 | ⊙              |  | 55             |                                   |
|                | 45   | RA..AL, RA..BL, RA..EM, RA..GM                 | MK/MKS 4504 F  |  | 60             | 42                                |
|                |  | RA..AN, RA..BN                                 | MK/MKS 4504 F  | PMK 45-10                                      | 70             |                                   |
|                | 55   | RA..AL, RA..BL, RA..EM, RA..GM                 | MK/MKS 5504 F  |  | 70             | 22                                |
| RA..AN, RA..BN |  | MK/MKS 5504 F                                  | PMK 55-13      | 80   |                |                                   |
| 65             | RA..EM, RA..GM, RA..AN, RA..BN                 | MK/MKS 6504 F                                  | PMK 65-12      | 90   | 34             |                                   |

Rail manufacturer

**ROLLON**

|    |    |  |               |           |    |    |
|----|----|--|---------------|-----------|----|----|
| MR | 15 | MRS, MRS..C, MRT..W, MRT..SW                           | MK/MKS 1501 A |           | 24 | 1  |
|    |    | MRS..W   | MK/MKS 1501 A | PMK 15-4  | 28 |    |
|    | 20 | MRT..S, MRT..SC, MRT..W, MRT..SW                       | MK/MKS 2001 A |           | 28 | 7  |
|    |    | MRS, MRS..L, MRS..C, MRS..LC, MRS..W, MRS..LW          | MK/MKS 2001 A | PMK 20-2  | 30 |    |
|    | 25 | MRT, MRT..S, MRT..C, MRT..SC, MRT..W, MRT..SW, MRT..LW | ⊙             |           | 33 |    |
|    |    | MRS, MRS..L, MRS..C, MRS..LC                           | MK/MKS 2501 A |           | 36 | 19 |
|    |    | MRS..W, MRS..LW  | MK/MKS 2501 A | PMK 25-4  | 40 |    |
|    | 30 | MRS, MRS..L, MRS..C, MRS..LC, MRT..W, MRT..SW, MRT..LW | MK/MKS 3001 A |           | 42 | 29 |
|    |    | MRS..W, MRS..LW  | MK/MKS 3001 A | PMK 30-3  | 45 |    |
|    | 35 | MRS, MRS..L, MRT..W, MRT..SW, MRT..LW                  | MK/MKS 3501 A |           | 48 | 38 |
|    |    | MRS..W, MRS..LW  | MK/MKS 3501 A | PMK 35-7  | 55 |    |
|    | 45 | MRS, MRS..L, MRT..W, MRT..LW                           | MK/MKS 4501 A |           | 60 | 46 |
|    |    | MRS..W, MRS..LW  | MK/MKS 4501 A | PMK 45-10 | 70 |    |
|    | 55 | MRT..W, MRT..LW  | ⊙             |           | 68 |    |
|    |    | MRS, MRS..L  | MK/MKS 5501 A |           | 70 | 56 |
|    |    | MRS..W, MRS..LW  | MK/MKS 5501 A | PMK 55-10 | 80 |    |

\* PLUS connection not possible

\*1 Only required for high carriage design

\*2 Supplements the measure table and datasheet

See page 12 for part number explanation

| Type of rail                       | Size                               | Type of carriage                       | Item number   | Adapting plate <sup>*1</sup><br>(for height compensation) | Measure D [mm] | Measure table<br>(page 24 and 25) <sup>*2</sup> |   |
|------------------------------------|------------------------------------|--|---------------|---|----------------|---|---|
| LGR..T<br>LGR..R                   | 15                                 | LGW..CC,                               | MK/MKS 1501 A |   | 24             | 1   |   |
|                                    |                                    | LGH..CA                                | MK/MKS 1501 A | PMK 15-4  | 28             |   |   |
|                                    | 20                                 | LGW..CC, LGW..HC, LGH..CA, LGH..HA     |               | MK/MKS 2001 A   |                | 30  | 9 |
|                                    |                                    | LGW..CC, LGW..HC                       | MK/MKS 2501 A |   | 36             | 19  |   |
|                                    | 25                                 | LGH..CA, LGH..HA                       | MK/MKS 2501 A | PMK 25-4  | 40             |   |   |
|                                    |                                    | LGW..CC, LGW..HC                       | MK/MKS 3001 A |   | 42             | 29  |   |
|                                    | 30                                 | LGH..CA, LGH..HA                       | MK/MKS 3001 A | PMK 30-3  | 45             |   |   |
|                                    |                                    | LGW..CC, LGW..HC                       | MK/MKS 3501 A | PMK 35-4  | 48             | 37  |   |
|                                    | 35                                 | LGH..CA, LGH..HA                       | MK/MKS 3501 A | PMK 35-11   | 55             |   |   |
|                                    |                                    | LGW..CC, LGW..HC                       | MK/MKS 4501 A | PMK 45-8  | 60             | 43  |   |
| 45                                 | LGH..CA, LGH..HA                   | MK/MKS 4501 A                          | PMK 45-18     | 70  |                |   |   |
|                                    | LGW..CC, LGW..HC                   | MK/MKS 5501 A                          | PMK 55-4      | 70  | 53             |   |   |
| 55                                 | LGH..CA, LGH..HA                   | MK/MKS 5501 A                          | PMK 55-14     | 80  |                |   |   |
|                                    | LGW..CC, LGW..HC, LGH..CA, LGH..HA | MK/MKS 6501 A                          |               | 90  | 60             |   |   |
| HGR..T<br>HGR..R                   | 15                                 | HGW..CC                                | MK/MKS 1501 A |   | 24             | 1   |   |
|                                    |                                    | HGH..CA                                | MK/MKS 1501 A | PMK 15-4  | 28             |   |   |
|                                    | 20                                 | HGW..CC, HGW..HC, HGH..CA, HGH..HA     |               | MK/MKS 2001 A   |                | 30  | 9 |
|                                    |                                    | HGW..CC, HGW..HC                       | MK/MKS 2512 A |   | 36             | 19  |   |
|                                    | 25                                 | HGH..CA, HGH..HA                       | MK/MKS 2512 A | PMK 25-4  | 40             |   |   |
|                                    |                                    | HGW..CC, HGW..HC                       | MK/MKS 3001 A |   | 42             | 29  |   |
|                                    | 30                                 | HGH..CA, HGH..HA                       | MK/MKS 3001 A | PMK 30-3  | 45             |   |   |
|                                    |                                    | HGW..CC, HGW..HC                       | MK/MKS 3501 A |   | 48             | 38  |   |
|                                    | 35                                 | HGH..CA, HGH..HA                       | MK/MKS 3501 A | PMK 35-7  | 55             |   |   |
|                                    |                                    | HGW..CC, HGW..HC                       | MK/MKS 4501 A | PMK 45-2  | 60             | 45  |   |
|                                    | 45                                 | HGH..CA, HGH..HA                       | MK/MKS 4501 A | PMK 45-12   | 70             |   |   |
|                                    |                                    | HGW..CC, HGW..HC                       | MK/MKS 5501 A | PMK 55-2  | 70             | 55  |   |
|                                    | 55                                 | HGH..CA, HGH..HA                       | MK/MKS 5501 A | PMK 55-12   | 80             |   |   |
| HGW..CC, HGW..HC, HGH..CA, HGH..HA |                                    | MK/MKS 6501 A                          |               | 90  | 60             |   |   |
| EGR..T                             | 15                                 | EGH...SA, EGH...CA, EGW...SC, EGW...CC | MK/MKS 1501 A |   | 24             | 1   |   |
|                                    | 20                                 | EGH...SA, EGH...CA, EGW...SC, EGW...CC | MK/MKS 2001 A |   | 28             | 7   |   |
|                                    | 25                                 | EGH...SA, EGH...CA, EGW...SC, EGW...CC | MK/MKS 2501 A | PMK 25-2  | 33             | 20  |   |
|                                    | 30                                 | EGH...SA, EGH...CA, EGW...SC, EGW...CC | MK/MKS 3001 A | PMK 30-2  | 42             | 28  |   |
| RG..T                              | 25                                 | RGW..CC, RGW..HC                       | ⊗             |   | 36             | 19  |   |
|                                    |                                    | RGH..CA, RGH..HA                       | ⊗             |   | 40             |   |   |
|                                    | 30                                 | RGW..CC, RGW..HC                       | ⊗             |   | 42             | 29  |   |
|                                    |                                    | RGH..CA, RGH..HA                       | ⊗             |   | 45             |   |   |
|                                    | 35                                 | RGW..CC, RGW..HC                       | ⊗             |   | 48             | 38  |   |
|                                    |                                    | RGH..CA, RGH..HA                       | ⊗             |   | 55             |   |   |
|                                    | 45                                 | RGW..CC, RGW..HC                       | ⊗             |   | 60             | 45  |   |
|                                    |                                    | RGH..CA, RGH..HA                       | ⊗             |   | 70             |   |   |
|                                    | 55                                 | RGW..CC, RGW..HC                       | ⊗             |   | 70             | 55  |   |
|                                    |                                    | RGH..CA, RGH..HA                       | ⊗             |   | 80             |   |   |
| 65                                 | RGW..CC, RGW..HC                   | ⊗                                      |               | 90  | 60             |   |   |
|                                    | RGH..CA, RGH..HA                   | ⊗                                      |               | 90  |                |   |   |

Rail manufacturer

**HIWIN**  
 Lineartechnologie
\*<sup>1</sup> Only required for high carriage design\*<sup>2</sup> Supplements the measure table and datasheet

See page 12 for part number explanation

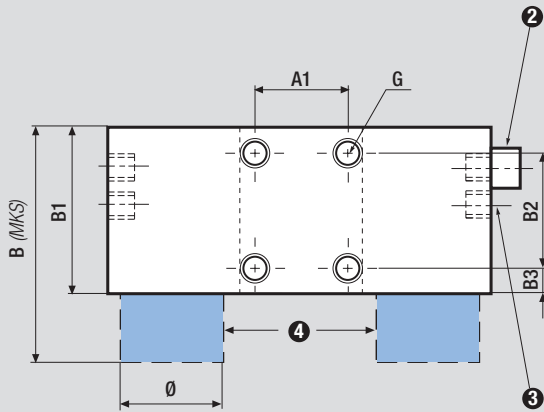
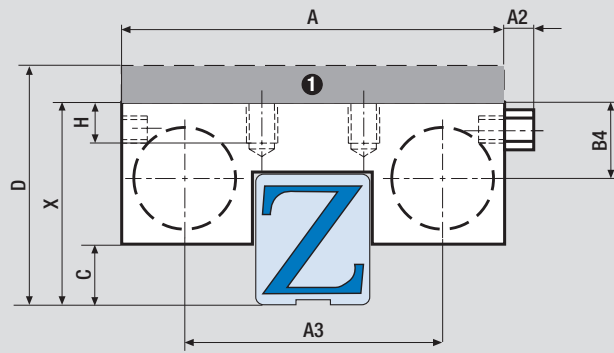

**Note:** Consider measurement C!

Air connections are located on both sides and can be exchanged according to mounting requirements.

Only one connection is necessary for function.

- ❶ Adapter plate PMK (accessory)
- ❷ MK Series: Air filter  
MKS: M5 port (air connection)
- ❸ MK Series: M5 port (air connection)  
MKS: Air filter / Plus connection M5.
- ❹ Mounting of spring unit at MKS is omitted at MK.

| Measure table | Holding Power [N] MK | Holding Power [N] MKS | A [mm] | A1 [mm] | A2 [mm] | A3 [mm] | B [mm] | B1 [mm] | B2 [mm] | B3 [mm] | B4 [mm] | C [mm] | X [mm] | G   | H [mm] | Ø  |
|---------------|----------------------|-----------------------|--------|---------|---------|---------|--------|---------|---------|---------|---------|--------|--------|-----|--------|----|
| 1             | 650                  | 400                   | 55     | 15      | 6       | 34      | 58     | 39      | 15      | 15,5    | 12      | 2,5    | 24     | M4  | 4,5    | 16 |
| 2             | 650                  | 400                   | 55     | 15      | 6       | 34      | 58     | 39      | 15      | 15,5    | 11,6    | 3,2    | 24     | M4  | 4,5    | 16 |
| 3             | 1750                 | 1050                  | 142    | 22      | 5       | 110     | 68     | 39      | 22      | 8,5     | 20,5    | 7      | 42     | M8  | 10     | 25 |
| 4             | 650                  | 400                   | 55     | 15      | 6       | 34      | 58     | 39      | 15      | 15,5    | 12      | 6,5    | 28     | M4  | 4,5    | 16 |
| 5             | 650                  | 400                   | 60     | 15      | 5       | 39      | 68     | 59      | 25      | 12      | 10,5    | 4,5    | 24     | M5  | 6      | 16 |
| 6             | 1000                 | 600                   | 66     | 20      | 6       | 43      | 61     | 39      | 20      | 5       | 14,4    | 1,5    | 27     | M5  | 5      | 20 |
| 7             | 1000                 | 600                   | 66     | 20      | 6       | 43      | 61     | 39      | 20      | 5       | 14,4    | 2,5    | 28     | M5  | 5      | 20 |
| 8             | 1000                 | 600                   | 66     | 20      | 5       | 43      | 61     | 39      | 20      | 9       | 15,5    | 3      | 30     | M6  | 6      | 20 |
| 9             | 1000                 | 600                   | 66     | 20      | 6       | 43      | 61     | 39      | 20      | 5       | 14,4    | 4,5    | 30     | M5  | 5      | 20 |
| 10            | 1200                 | 750                   | 70     | 20      | 5       | 47      | 61     | 39      | 20      | 5       | 19,5    | 5      | 36     | M6  | 8      | 20 |
| 11            | 460                  | 440                   | 70     | 15      | 5       | 50,6    | 64     | 48      | 15      | 8,5     | 8,3     | 1,2    | 17     | M5  | 7,5    | 12 |
| 12            | 1200                 | 750                   | 75     | 20      | 5       | 49      | 56     | 35      | 20      | 5       | 15,5    | 3      | 31     | M6  | 8      | 22 |
| 13            | 1000                 | 600                   | 88     | 20      | 5       | 65      | 61     | 39      | 20      | 5       | 14,4    | 4,5    | 30     | M5  | 5,5    | 20 |
| 14            | 1200                 | 750                   | 75     | 20      | 5       | 49      | 56     | 35      | 20      | 5       | 20      | 3,5    | 36     | M6  | 8      | 22 |
| 15            | 1200                 | 750                   | 90     | 22      | 5       | 64      | 60     | 39      | 22      | 8,5     | 24,5    | 5      | 42     | M8  | 9      | 22 |
| 16            | 1200                 | 750                   | 75     | 20      | 5       | 49      | 56     | 35      | 20      | 5       | 15,5    | 4      | 32     | M6  | 8      | 22 |
| 17            | 1200                 | 750                   | 75     | 20      | 5       | 49      | 56     | 35      | 20      | 5       | 15,5    | 5      | 33     | M6  | 8      | 22 |
| 18            | 1200                 | 750                   | 75     | 20      | 6       | 49      | 56     | 35      | 20      | 5       | 15,5    | 6      | 34     | M6  | 8      | 22 |
| 19            | 1200                 | 750                   | 75     | 20      | 5       | 49      | 56     | 35      | 20      | 5       | 15,5    | 8      | 36     | M6  | 8      | 22 |
| 20            | 1200                 | 750                   | 75     | 20      | 5       | 49      | 56     | 35      | 20      | 5       | 15,5    | 3,0    | 31     | M6  | 8      | 22 |
| 21            | 1200                 | 750                   | 75     | 20      | 5       | 49      | 56     | 35      | 20      | 5       | 15,5    | 12     | 40     | M6  | 8      | 22 |
| 22            | 3000                 | 2000                  | 128    | 30      | 5       | 86,8    | 82     | 49      | 30      | 9,5     | 40      | 10     | 67     | M10 | 15     | 30 |
| 23            | 1200                 | 750                   | 75     | 20      | 5       | 49      | 65     | 54      | 20      | 12      | 12,5    | 5      | 30     | M6  | 8      | 22 |
| 24            | 650                  | 400                   | 77     | 15      | 5       | 56      | 58     | 49      | 15      | 21,5    | 9,6     | 2      | 21     | M5  | 5      | 16 |
| 25            | 1000                 | 600                   | 88     | 20      | 5       | 65      | 65     | 53      | 20      | 19,5    | 11,5    | 4      | 27     | M6  | 6      | 20 |
| 26            | 1750                 | 1050                  | 90     | 22      | 5       | 58      | 68     | 39      | 22      | 8,5     | 20,5    | 3      | 38     | M8  | 10     | 25 |
| 27            | 1750                 | 1050                  | 90     | 22      | 5       | 58      | 68     | 39      | 22      | 8,5     | 24      | 3,5    | 42     | M8  | 9      | 25 |
| 28            | 1750                 | 1050                  | 90     | 22      | 5       | 58      | 68     | 39      | 22      | 8,5     | 20,5    | 5      | 40     | M8  | 10     | 25 |
| 29            | 1750                 | 1050                  | 90     | 22      | 5       | 58      | 68     | 39      | 22      | 8,5     | 20,5    | 7      | 42     | M8  | 10     | 25 |
| 30            | 1750                 | 1050                  | 90     | 22      | 5       | 58      | 68     | 39      | 22      | 8,5     | 20,5    | 10     | 45     | M8  | 10     | 25 |
| 31            | 1750                 | 1050                  | 90     | 22      | 5       | 58      | 78     | 59      | 22      | 13,5    | 14      | 5      | 33     | M8  | 8      | 25 |
| 32            | 1750                 | 1050                  | 96     | 20      | 5       | 64      | 73     | 54      | 20      | 10      | 15,5    | 8,5    | 38     | M8  | 10     | 25 |
| 33            | 2000                 | 1250                  | 100    | 24      | 5       | 68      | 67     | 39      | 24      | 7,5     | 20,5    | 3,5    | 40     | M8  | 10     | 28 |
| 34            | 3000                 | 2000                  | 138    | 30      | 5       | 96,8    | 82     | 49      | 30      | 9,5     | 43,7    | 14,5   | 78     | M10 | 15     | 30 |
| 35            | 2000                 | 1250                  | 100    | 24      | 5       | 68      | 67     | 39      | 24      | 7,5     | 20,5    | 4      | 48     | M8  | 10     | 28 |
| 36            | 2000                 | 1250                  | 100    | 24      | 5       | 68      | 67     | 39      | 24      | 7,5     | 20,5    | 8,5    | 45     | M8  | 10     | 28 |
| 37            | 2000                 | 1250                  | 100    | 24      | 5       | 68      | 67     | 39      | 24      | 7,5     | 20,5    | 7,5    | 44     | M8  | 10     | 28 |
| 38            | 2000                 | 1250                  | 100    | 24      | 5       | 68      | 67     | 39      | 24      | 7,5     | 20,5    | 11,5   | 48     | M8  | 10     | 28 |
| 39            | 3000                 | 2000                  | 138    | 30      | 5       | 96,8    | 82     | 49      | 30      | 9,5     | 43,7    | 11,5   | 75     | M10 | 15     | 30 |
| 40            | 3000                 | 2000                  | 128    | 30      | 5       | 86,8    | 82     | 49      | 30      | 9,5     | 36,2    | 10     | 63     | M10 | 15     | 30 |
| 41            | 1200                 | 750                   | 120    | 50      | 5       | 94      | 56     | 35      | 20      | 5       | 20      | 2,5    | 35     | M6  | 8      | 22 |
| 42            | 2250                 | 1450                  | 120    | 26      | 5       | 78,8    | 82     | 49      | 26      | 11,5    | 35,5    | 8      | 60     | M10 | 15     | 30 |
| 43            | 2250                 | 1450                  | 120    | 26      | 5       | 78,8    | 82     | 49      | 26      | 11,5    | 26,8    | 8,5    | 52     | M10 | 15     | 30 |
| 44            | 2250                 | 1450                  | 120    | 26      | 5       | 78,8    | 82     | 49      | 26      | 11,5    | 26,8    | 10,5   | 54     | M10 | 15     | 30 |
| 45            | 2250                 | 1450                  | 120    | 26      | 5       | 78,8    | 82     | 49      | 26      | 11,5    | 26,8    | 14,5   | 58     | M10 | 15     | 30 |
| 46            | 2250                 | 1450                  | 120    | 26      | 5       | 78,8    | 82     | 49      | 26      | 11,5    | 26,8    | 16,5   | 60     | M10 | 15     | 30 |
| 47            | 2250                 | 1450                  | 138    | 30      | 5       | 97      | 82     | 49      | 30      | 9,5     | 42      | 16     | 75     | M10 | 15     | 30 |
| 48            | 1200                 | 750                   | 75     | 20      | 5       | 49      | 56     | 35      | 20      | 5       | 15,3    | 3,5    | 31     | M6  | 7,5    | 22 |
| 49            | 1200                 | 750                   | 121    | 50      | 5       | 95      | 57     | 36      | 20      | 5       | 17,5    | 5      | 35     | M8  | 10     | 22 |
| 50            | 3000                 | 2000                  | 128    | 30      | 5       | 86,8    | 82     | 49      | 30      | 9,5     | 40      | 13     | 70     | M10 | 15     | 30 |
| 51            | 2250                 | 1450                  | 130    | 26      | 5       | 88,8    | 82     | 49      | 26      | 11,5    | 26,8    | 16,5   | 60     | M10 | 15     | 30 |
| 52            | 2250                 | 1450                  | 128    | 30      | 5       | 87      | 82     | 49      | 30      | 9,5     | 30,5    | 14,5   | 63     | M10 | 18     | 30 |
| 53            | 2250                 | 1450                  | 128    | 30      | 5       | 87      | 82     | 49      | 30      | 9,5     | 30,5    | 15,5   | 64     | M10 | 18     | 30 |
| 54            | 2250                 | 1450                  | 120    | 26      | 5       | 78,8    | 82     | 49      | 26      | 11,5    | 27,5    | 8      | 52     | M10 | 13,8   | 30 |
| 55            | 2250                 | 1450                  | 128    | 30      | 5       | 87      | 82     | 49      | 30      | 9,5     | 30,5    | 19,5   | 68     | M10 | 18     | 30 |
| 56            | 2250                 | 1450                  | 128    | 30      | 5       | 87      | 82     | 49      | 30      | 9,5     | 30,5    | 21,5   | 70     | M10 | 18     | 30 |
| 57            | 650                  | 400                   | 77     | 15      | 5       | 56      | 58     | 39      | 15      | 21,5    | 9,6     | 2      | 21     | M5  | 5      | 16 |
| 58            | 650                  | 400                   | 80     | 20      | 5       | 59      | 58     | 39      | 20      | 15,5    | 14      | 3,5    | 27     | M4  | 4,5    | 16 |
| 59            | 3000                 | 2000                  | 138    | 30      | 5       | 96,8    | 82     | 49      | 30      | 9,5     | 55      | 16,5   | 90     | M10 | 20     | 30 |
| 60            | 2250                 | 1450                  | 138    | 30      | 5       | 96,8    | 82     | 49      | 30      | 9,5     | 46      | 27     | 90     | M10 | 19     | 30 |
| 61            | 1200                 | 750                   | 75     | 20      | 5       | 50,4    | 56     | 35      | 20      | 5       | 15,5    | 3      | 31     | M6  | 8      | 22 |
| 62            | 2000                 | 1250                  | 156    | 60      | 5       | 124     | 67     | 39      | 20      | 9,5     | 29,5    | 4,5    | 50     | M10 | 10     | 28 |
| 63            | 2000                 | 1250                  | 156    | 60      | 5       | 124     | 70     | 42      | 20      | 9,5     | 30      | 4,5    | 50     | M10 | 10     | 28 |
| 64            | 650                  | 400                   | 64     | 15      | 6       | 45,4    | 58     | 39      | 15      | 15,5    | 12      | 2,5    | 24     | M4  | 4,5    | 16 |
| 65            | 1200                 | 750                   | 84     | 20      | 5       | 58      | 56     | 35      | 20      | 5       | 15,5    | 8      | 36     | M6  | 8      | 22 |
| 66            | 1200                 | 750                   | 114    | 24      | 5       | 82      | 67     | 39      | 24      | 7,5     | 20,5    | 11,5   | 48     | M8  | 10     | 28 |