

Rail manufacturer



Type of rail	Size	Type of carriage	Item number	Measure D [mm] <sup>*2</sup>	Measure table [page 67]
SRS	9	SRS..M	MCP/MCPS 0901 H	10	5
	12	SRS..M	MCP/MCPS 1201 A	13	2
	15	SRS..M	MCP/MCPS 1501 A	16	3
	20	SRS..M	MCP/MCPS 2001 A	20	4
RSR	3	RSR..M, RSR..N	Ⓢ		4
	5	RSR..M, RSR..N	Ⓢ		6
	7	RSR..M, RSR..N, RSR..ZM	Ⓢ		8
	9	RSR..KM, RSR..N, RSR..ZM	MCP/MCPS 0901 A	10	1
	12	RSR..VM, RSR..N, RSR..ZM	Ⓢ		13
	15	RSR..VM, RSR..N, RSR..ZM	Ⓢ		16
	20	RSR..VM, RSR..N	Ⓢ		20

Rail manufacturer



0445	7	0442..7, 0444..7	Ⓢ		8
	9	0442..9/M3, 0442..9/M2, 0444..9/M3	MCP/MCPS 0901 A	10	1
	12	0442..12, 0444..12	MCP/MCPS 1205 A	13	2
	15	0442..15, 0444..15	Ⓢ		16
	20	0442..20	Ⓢ		25

Rail manufacturer



MN	7	MNN	Ⓢ		8
	9	MNN	MCP/MCPS 0901 A	10	1
	12	MNN	MCP/MCPS 1201 A	13	2
	15	MNN	MCP/MCPS 1504 A	16	3

Rail manufacturer



LWL	5	LWLC..B, LWLC..N, LWL..B, LWL..N	Ⓢ		6
	7	LWLC..B, LWLC..N, LWL..B, LWL..N, LWLG..B, LWLG..N	Ⓢ		8
	9	LWLC..B, LWLC..N, LWL..B, LWL..N, LWL..BCS, LWLG..B, LWLG..N	MCP/MCPS 0901 A	10	1
	12	LWLC..B, LWL..B, LWL..BCS, LWLG..B	MCP/MCPS 1201 A	13	2
	15	LWLC..B, LWL..B, LWL..BCS, LWLG..B	MCP/MCPS 1504 A	16	3
	20	LWLC..B, LWL..B, LWL..BCS, LWLG..B	MCP/MCPS 2001 A	20	4
25	LWLC..B, LWL..B, LWLG..B,	Ⓢ		25	

Rail manufacturer



TKDM (KUME)	5	KWEM, KWEM..-C	Ⓢ		6
	7	KWEM, KWEM..-L, KWEM..-C	Ⓢ		8
	9	KWEM, KWEM..-L, KWEM..-C	MCP/MCPS 0901 A	10	1
	12	KWEM, KWEM..-L, KWEM..-C	MCP/MCPS 1201 A	13	2
	15	KWEM, KWEM..-L, KWEM..-C	MCP/MCPS 1504 A	16	3

Rail manufacturer



MGN	9	MGN..C, MGN..H	MCP/MCPS 0901 A	10	1
	12	MGN..C, MGN..H	MCP/MCPS 1201 A	13	2
	15	MGN..C, MGN..H	MCP/MCPS 1504 A	16	3

Rail manufacturer



LU PU	5	LU..TL, PU..TR	Ⓢ		6
	7	LU..AL, PU..AR	Ⓢ		8
	9	LU..AR, LU..TR, LU..AL, LU..TL, LU..BL, LU..UL, PU..TR	MCP/MCPS 0901 A	10	1
	12	LU..AR, LU..TR, LU..AL, LU..TL, LU..BL, LU..UL, PU..TR	MCP/MCPS 1201 A	13	2
	15	LU..AL, LU..BL, PU..AL	MCP/MCPS 1504 A	16	3

\*2 Supplements the measure table and datasheet

See page 12 for part number explanation

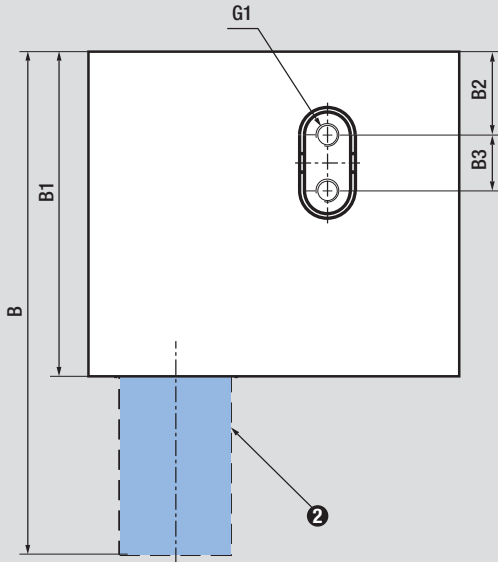
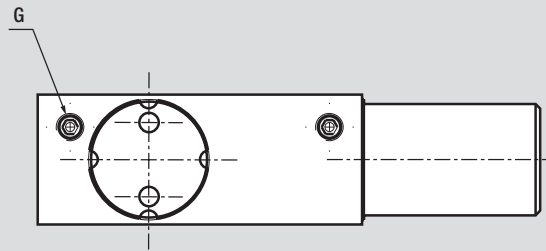
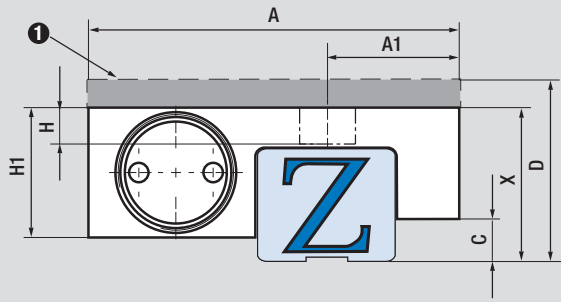

**Note:** Consider measurement C!

G1: Air connection

① Adapting plate PMB (accessories)

② mounting of piston unit

MC

Measure table	Holding power [N] MC	Holding power [N] MKS	A [mm]	A1 [mm]	B [mm]	B1 [mm]	B2 [mm]	B3 [mm]	C [mm]	X [mm]	G	G1	H [mm]	H1 [mm]
1	200	170	32,5	9,7	53	34	8,25	5,5	2,15	10	M3	M2,5	3,3	15
2	280	240	37,5	13,2	53,2	34	8,25	5,5	2,95	13	M3	M2,5	3,5	16
3	320	280	41,5	15,7	53,2	34	8	6	3,95	16	M3	M2,5	3,8	16
4	550	400	48,7	19,7	60	41	10,5	8	2,45	20	M3	M4	6,2	23
5	200	170	32	9,2	46	34	8,25	5,5	2,05	10	M3	M2,5	3,3	14